

Starcon Lifting eye standard coupling

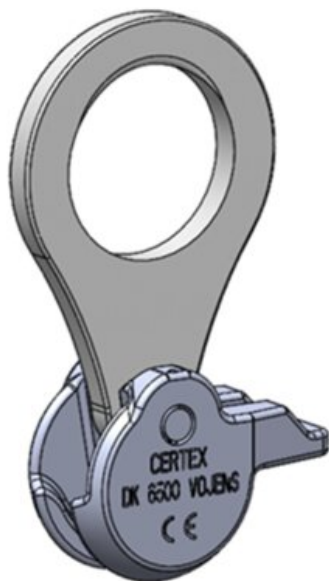

Product information

The Starcon lifting eye standard coupling joint is used for lifting spherical anchors embedded in precast concrete elements. The spherical claw grabs the head of the spherical anchor. The standard lifting eye can be mounted to a crane hook or other lifting gear. The plate can rotate around the lifting eye, which enables lifting with different inclinations. The equipment can be reused for many lifting operations.

Areas of application: Used for Starcon spherical anchor.

Advantages: Quick connection and disconnection of anchor.

The self-locking lifting eye prevents accidental release, while the lifting eye can rotate freely around the axis of the anchor.

Its unique geometry allows the anchors to carry their full load even when pulled perpendicularly.

Load group: 1.3t – 20t

Technical information: CE marking according to MD 2006/42 EF

Starcon product is designed according to EN13155-2009 and follows the guidelines of VDI/BV-BS 6205 and DS/CEN/TR 15728.

Marking: CE-marked, batch code, load group + S(Starcon)

Finish: Electro-galvanized - Corrosion class C3 - ISO 12944-2.

| Part Code | Load grp. t | d mm | L mm | Ø mm | Weight kg |
|--------------|-------------|------|------|------|-----------|
| 650220013001 | 1-1.3 | 34 | 130 | 42 | 0.61 |
| 650220025001 | 1.5-2.5 | 42 | 165 | 60 | 1.12 |
| 650220050001 | 3-5.0 | 55 | 200 | 62 | 2.39 |
| 650220100001 | 6-10.0 | 74 | 285 | 100 | 5.6 |
| 650220200001 | 12-20.0 | 110 | 370 | 120 | 13.38 |

Blueprint

